

钢包秤、天车秤
Steel embody scale, overhead crane scale

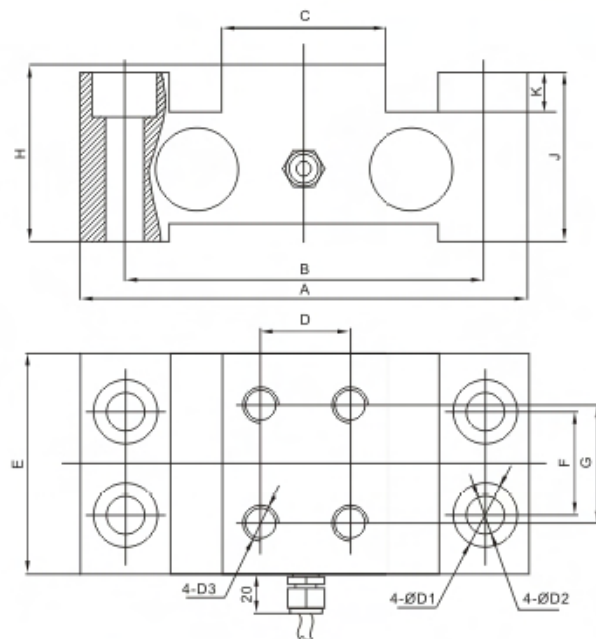

额定载荷(t) Rated Load	A	B	C	D	E	F	G	H	J	K	D1	D2	D3
10	200	170	85	60	80	50	50	60	50	7	26	18	M16
20,30	300	240	110	60	120	70	70	120	115	28	43	26	M24
40,50	300	240	110	60	150	70	80	120	115	30.5	43	26	M24

TECHNICAL PARAMETER | 4Wires:Exc+(红,Red);Exc-(黑,Black);Sig+(绿,Green);Sig-(白,White)

额定载荷 Rated capacities(Emax)	10,20,30,40,50t	温度补偿范围 Temperature range, compensated	-10℃~+40℃
灵敏度 Sensitivity	1.8±0.005mV/V(10t);2.0±0.005mV/V(20t);1.2±0.005mV/V(30t);1.8±0.005mV/V(40~50t)	工作温度范围 Temperature range, operating	-30~+70℃
综合误差 Total error	±0.2%F.S	安全过载 Maximum safe overload	150%F.S
蠕变(30分钟)Creep error (30min)	±0.03%F.S	极限过载 Ultimate overload	300%F.S
零点平衡 Zero balance	±1%F.S	推荐激励电压 Excitation,recommend	10~12V DC
零点温度影响 TCO	±0.02%F.S/10℃	最大激励电压 Excitation,maximum	15V DC
输出温度影响 TC SPAN	±0.02%F.S/10℃	防封等级 Protection class	IP67
输入阻抗 Input impedance	750±10Ω	材质 Construction	合金钢Alloy Steel
输出阻抗 Output impedance	702±3Ω,703±5Ω(L≥15m)	电缆 Cable	Length=L:12m(10t),14m(20~30t),16m(40,50t)
绝缘电阻 Insulation impedance	≥5000MΩ		Diameter: φ6mm