

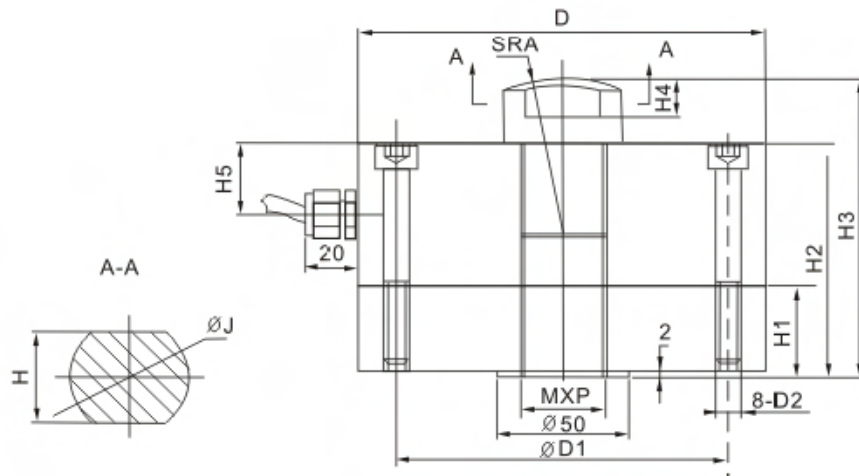

额定载荷(t) Rated Load	D	M*P	H1	H2	H3	H4	H5	H	φJ	A	D1	D2
1,2,3	φ 105	M14*2	25	70	85	10	22.5	20	φ 25	40	90	M6x55
5	φ 120	M20*1.5	30	80	95	10	25	25	φ 30	45	104.5	M8x65
10,20	φ 155	M32*2	35	90	115	15	27.5	35	φ 45	60	133	M10x75



轴重秤、仓储秤、实验机

Axle-load scale, warehouse scale, experimental machine

## TECHNICAL PARAMETER

4Wires:Exc+(红,Red);Exc-(黑,Black);Sig+(绿,Green);Sig-(白,White)

额定载荷 Rated capacities(Emax)	1,2,3,5,10,20t	温度补偿范围 Temperature range, compensated	-10℃~+40℃
灵敏度 Sensitivity	2.0±0.006mV/V	工作温度范围 Temperature range, operating	-30~+70℃
综合误差 Total error	±0.05%F.S(2,3,5t);±0.1%F.S ( 10,20t )	安全过载 Maximum safe overload	150%F.S
蠕变(30分钟)Creep error (30min)	±0.03%F.S	极限过载 Ultimate overload	200%F.S
零点平衡 Zero balance	±1%F.S	推荐激励电压 Excitation,recommend	10~12V DC
零点温度影响 TCO	±0.02%F.S/10℃	最大激励电压 Excitation,maximum	15V DC
输出温度影响 TC SPAN	±0.02%F.S/10℃	防封等级 Protection class	IP67
输入阻抗 Input impedance	400±20Ω	材质 Construction	合金钢Alloy Steel
输出阻抗 Output impedance	352±3Ω	电缆 Cable	Length:12m
绝缘电阻 Insulation impedance	≥5000MΩ		Diameter: φ 6mm