

量程	A	B	C	M
5~30kg	51	63.5	12.4	M6
50~200kg	51	76.2	19.1	M12

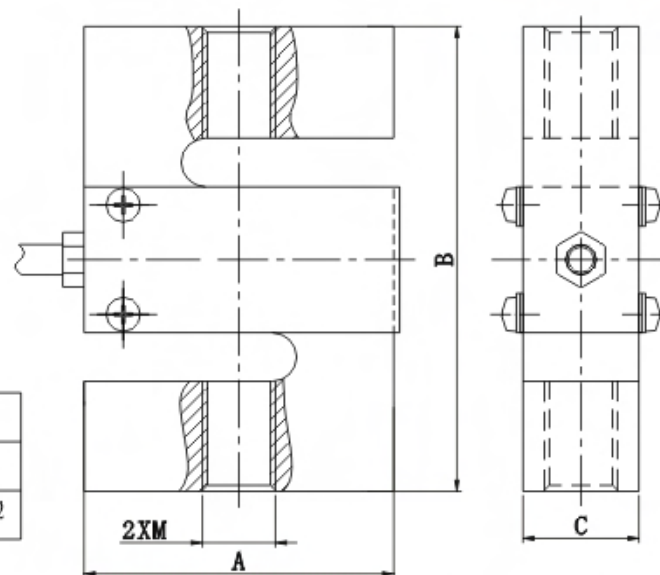

吊钩秤,皮带秤,配料秤

Crane scale,belt scale,blening scale

TECHNICAL PARAMETER | 4Wires:Exc+(红,Red);Exc-(黑,Black);Sig+(绿,Green);Sig-(白,White)

额定载荷 Rated load	5,10,15,20,50,100,200kg	绝缘电阻 Insulation resistance	≥5000MΩ
灵敏度 Sensitivity	1.0 ± 0.003mV/V(5 ~ 30kg)	工作温度范围 Operating Temp Range	-30 ~ +70℃
	2.0 ± 0.003mV/V(50 ~ 200kg)	安全过载 Safe load limit	150%F.S
综合误差 Total error	± 0.05%F.S	极限过载 Lateral load limit	200%F.S
蠕变 (30分钟) Creep(30min)	± 0.03%F.S	推荐激励电压 Recommend excitation	10 ~ 12V DC
零点平衡 Zero balance	± 2%F.S(5 ~ 30kg) ± 1%F.S(50 ~ 200kg)	最大激励电压 Maximum excitation	15V DC
零点温度影响 TCO	± 0.03%F.S/10℃	密封等级 Protection Class	IP65
输出温度影响 TC SPAN	± 0.03%F.S/10℃	材质 Construction	铝合金 Aluminium
输入阻抗 Input resistance	400 ± 20Ω	电缆 Cable	Length: 5m
输出阻抗 Output resistance	352 ± 3Ω		Diameter: φ5mm